



**IMPORTANT INFORMATION**

**Tools Needed**

- Putty Knife (1"-2")
- Putty Knife (4"-6")
- Screwdriver (#2, Phillips head)

**CAUTION: Panel removal and installation can be awkward and could cause physical injury or product damage; we recommend the help of additional people.**

**Operating Panel Removal**

1. On the interior, unlock the panel and slide to the middle. Make sure panel has slid past anti-lift blocks in the head track, if present.
2. Lift up on the panel so the top of the panel pushes fully up into the head of the door frame.

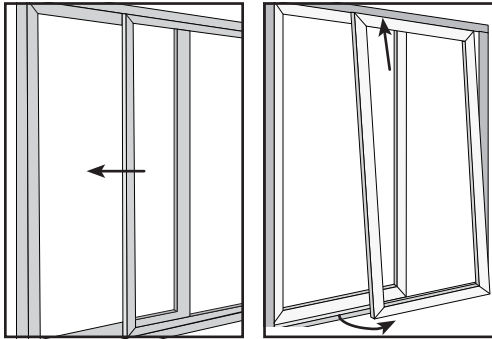

3. Swing the bottom of the door panel over the sill, towards the interior.  
**NOTE:** The rollers may have to be raised up into the panel and then held in place with a wide putty knife or similar flat tool in order to clear the back wall of the sill. Roller adjustment screws are located on the interior, lower rail of the door panel, possibly covered by vinyl dust caps/plugs.

**NOTE:** If you cannot remove the panel or it is very difficult to remove, the interlock may be removed to assist in the panel removal process. Refer to **steps 4, 5 and 6** below on how to remove the interlock.

**Removal of Active Panel Interlock**

4. Locate the interlock along the edge of the panel, located on the "opposite" side as the handle.
5. Starting at the top, insert a putty knife between the panel and the interlock. Gently pry to release the interlock from the panel top to bottom.
6. Remove the interlock from the panel and set aside.

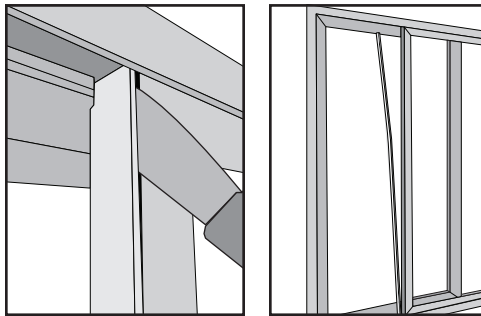

**Continue with steps 2 and 3 above to remove the operating panel.**

**Operating Panel Installation**

To install, reverse removal steps.

1. Lift the panel into the top of the door frame. Swing bottom of door over the sill, towards the exterior.
2. Check panel for proper operation. Adjust rollers and replace dust caps/plugs if needed. Close and lock door.

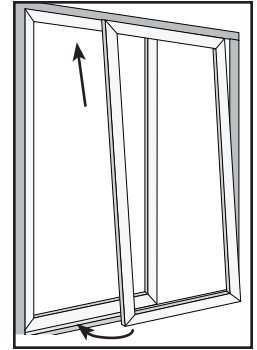

**NOTE:** If you removed the interlock, please proceed with **steps 3 and 4** below to install the interlock after reinstalling the panel.

**Install of Active Panel Interlock**

3. Reinstall the interlock by aligning it with the top of the panel and seating the exterior side first. Then firmly press the interior to snap into place.
4. Work from the top of the panel to the bottom.

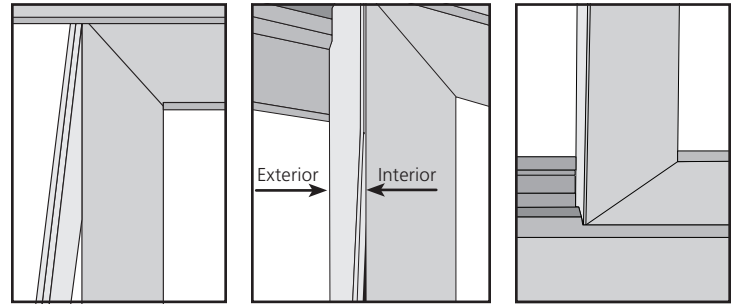

The advice offered herein can be done by a homeowner with some mechanical aptitude. If you are unsure, it is recommended that you hire a trained service provider such as a competent and licensed construction contractor or building professional. JELD-WEN disclaims any and all liability associated with the use and/or provision of these instructions. Any reliance upon the information or advice is at the risk of the party so relying. The information contained herein may be changed from time to time without notification.